

**LEGEND :**  
(PHASE-2)-PART-B :

S.No	BUILDING	STAGE	TOTAL FLOOR WISE AREAS IN SQ.MTS.					TOTAL AREA	
			1st Floor	2nd Floor	3rd Floor	4th Floor	5th Floor		
11	PROPOSED BLOCK FOR TEACHING STAFF QUARTERS (G+4)	TO BE CONSTRUCTED	664.57 Sq.mt.	664.57 Sq.mt.	664.57 Sq.mt.	664.57 Sq.mt.	664.57 Sq.mt.	4187.42 Sq.mt.	
13B1	PROPOSED BLOCK FOR NON TEACHING STAFF QUARTERS WITH LIFT (G+4)	TO BE CONSTRUCTED	455.53 Sq.mt.	455.53 Sq.mt.	455.53 Sq.mt.	455.53 Sq.mt.	455.53 Sq.mt.	2277.65 Sq.mt.	
13B2	PROPOSED BLOCK 2 FOR NON TEACHING STAFF QUARTERS WITH OUT LIFT (G+2)	TO BE CONSTRUCTED	458.30 Sq.mt.	449.44 Sq.mt.	---	---	---	1587.18 Sq.mt.	
19A	PROPOSED BLOCK FOR G.P. & S.P. RESIDENTS (G+4)	TO BE CONSTRUCTED	523.88 Sq.mt.	520.26 Sq.mt.	520.26 Sq.mt.	520.26 Sq.mt.	520.26 Sq.mt.	2601.02 Sq.mt.	
30A	SEPTIC TANK (2 Lakh liter capacity)	TO BE CONSTRUCTED	---	---	---	---	---	---	
30B	OVER HEAD TANK (2 Lakh liter capacity)	TO BE CONSTRUCTED	---	---	---	---	---	---	
31A	SEPTIC TANK (1 Lakh liter capacity)	TO BE CONSTRUCTED	---	---	---	---	---	---	
			<b>TOTAL</b>					<b>94839.65 Sq.mt.</b>	

**LEGEND :**  
(PHASE-1)-PART-A :

S.No	BUILDING	STAGE	TOTAL FLOOR WISE AREAS IN SQ.MTS.			TOTAL AREA
			1st Floor	2nd Floor	3rd Floor	
01	SECURITY	COMPLETED	24.11 Sq.mt.	---	---	24.11 Sq.mt.
02	HOSPITAL BUILDING	COMPLETED	2006.54 Sq.mt.	873.24 Sq.mt.	748.88 Sq.mt.	3128.30 Sq.mt.
03	AUDITORIUM	COMPLETED	1450.10 Sq.mt.	---	---	1450.10 Sq.mt.
04	MEDICAL COLLEGE	COMPLETED	5219.20 Sq.mt.	4881.11 Sq.mt.	3263.68 Sq.mt.	10707.75 Sq.mt.
05	NURSING COLLEGE	COMPLETED	---	---	4669.75 Sq.mt.	4669.75 Sq.mt.
06	MECHANIZED LAUNDRY	TO BE CONSTRUCTED	2268.80 Sq.mt.	---	---	2268.80 Sq.mt.
07	NURSES HOSTEL	COMPLETED	1417.10 Sq.mt.	1181.20 Sq.mt.	---	4098.70 Sq.mt.
08	MALE INTERNS HOSTEL	GROUND FLOOR COMPLETED	---	---	---	---
09	BOYS HOSTEL	GROUND FLOOR UNDER CONSTRUCTION	2268.75 Sq.mt.	2262.60 Sq.mt.	1939.60 Sq.mt.	6866.95 Sq.mt.
10	PROFESSORS QUARTERS	COMPLETED	342.00 Sq.mt.	342.00 Sq.mt.	342.00 Sq.mt.	1026.00 Sq.mt.
11	TEACHING STAFF QUARTERS	COMPLETED	458.20 Sq.mt.	458.20 Sq.mt.	---	916.40 Sq.mt.
12	PRINCIPAL QUARTERS	COMPLETED	228.30 Sq.mt.	---	---	228.30 Sq.mt.
13	SUPERINTENDANT QUARTERS	COMPLETED	228.30 Sq.mt.	---	---	228.30 Sq.mt.
14	CLASSIV STAFF QUARTERS	COMPLETED	334.80 Sq.mt.	284.50 Sq.mt.	---	619.30 Sq.mt.
15	NONTEACHING STAFF QUARTERS	COMPLETED	334.80 Sq.mt.	334.80 Sq.mt.	---	669.60 Sq.mt.
16	GIRLS HOSTEL	GROUND & 1st FLOORS COMPLETED	2268.00 Sq.mt.	1856.40 Sq.mt.	---	4124.40 Sq.mt.
17	FEMALE INTERNS HOSTEL	GROUND FLOOR COMPLETED	1417.10 Sq.mt.	1181.20 Sq.mt.	---	4098.70 Sq.mt.
18	RESIDENTS QUARTERS	GROUND FLOOR UNDER CONSTRUCTION	---	---	---	---
19	BURIAL GROUND	COMPLETED	108.00 Sq.mt.	---	---	108.00 Sq.mt.
20	ANIMAL HOUSE	TO BE CONSTRUCTED	177.00 Sq.mt.	---	---	177.00 Sq.mt.
21	PAN & USE TOILETS	TO BE CONSTRUCTED	244.00 Sq.mt.	---	---	244.00 Sq.mt.
22	CANTEN	TO BE CONSTRUCTED	142.00 Sq.mt.	---	---	142.00 Sq.mt.
23	ATTENDANTS SHED	TO BE CONSTRUCTED	142.00 Sq.mt.	---	---	142.00 Sq.mt.
24	SHOPPING COMPLEX / POLICE OUTPOST	TO BE CONSTRUCTED	722.50 Sq.mt.	---	---	722.50 Sq.mt.
25	CENTRAL MARK SHED	COMPLETED	477.20 Sq.mt.	---	---	477.20 Sq.mt.
26	CENTRAL MARK SHED	COMPLETED	381.70 Sq.mt.	---	---	381.70 Sq.mt.
27	EXISTING OPTICAL BLOCK	COMPLETED	42.70 Sq.mt.	---	---	42.70 Sq.mt.
28	ELECTRICAL SUBSTATION	COMPLETED	342.14 Sq.mt.	---	---	342.14 Sq.mt.
29	TRANSPORER YARD	COMPLETED	342.14 Sq.mt.	---	---	342.14 Sq.mt.
30	OVER HEAD TANK (1 Lakh liter)	TO BE CONSTRUCTED	---	---	---	---
30A	OVER HEAD TANK	TO BE CONSTRUCTED	---	---	---	---
31	SEPTIC TANK	COMPLETED	---	---	---	---
32	3 LAKH LITRES SLUMP	TO BE CONSTRUCTED	---	---	---	---
33	5 LAKH LITRES SLUMP	TO BE CONSTRUCTED	---	---	---	---
34	BASKET BALL COURT	TO BE CONSTRUCTED	---	---	---	---
35	PARKING COURT	TO BE CONSTRUCTED	---	---	---	---
36	PARKING SHEDS	TO BE CONSTRUCTED	---	---	---	---
37	CONVERSION OF EXISTING CENTRE AS RESIDENT QUARTERS	TO BE CONSTRUCTED	---	---	---	---
			<b>TOTAL</b>			<b>94839.65 Sq.mt.</b>

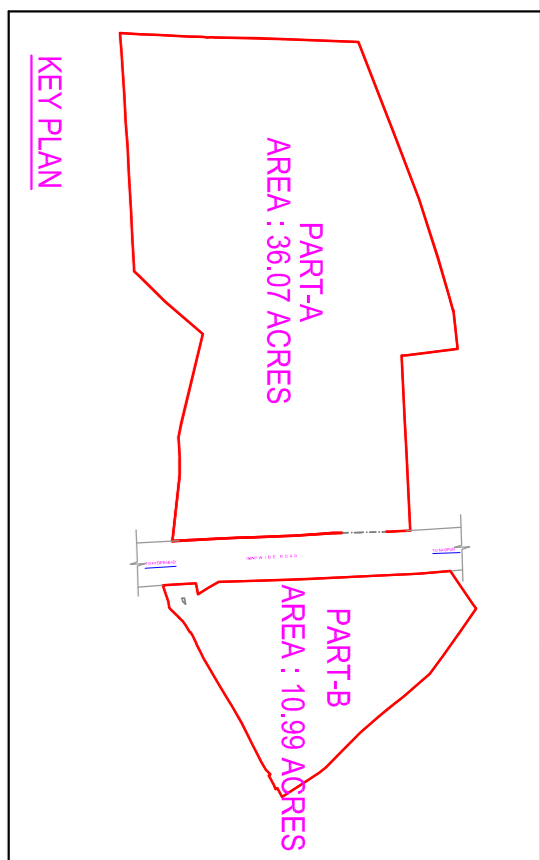

copy right of this drawing belongs to M/S. S.S. CONSULTANTS AND SHOULD NOT BE USED FOR ANY PURPOSE OTHER THAN SPECIFIED WITHOUT PRIOR PERMISSION.

**NORTH :**

**LEGEND :**

- [Pattern] = EXISTING
- [Pattern] = PROPOSED BUILDINGS
- [Pattern] = COMPLETED BUILDINGS
- [Pattern] = UNDER CONSTRUCTION
- [Pattern] = FUTURE EXPANSION BUILDINGS
- [Pattern] = SEPTIC TANK
- [Pattern] = NATURAL GROUND LEVEL
- [Pattern] = ROAD TOP LEVEL
- [Pattern] = FINISHED GROUND LEVEL
- [Pattern] = FINISHED FLOOR LEVEL
- [Pattern] = PORTICO FINISHED FLOOR LEVEL

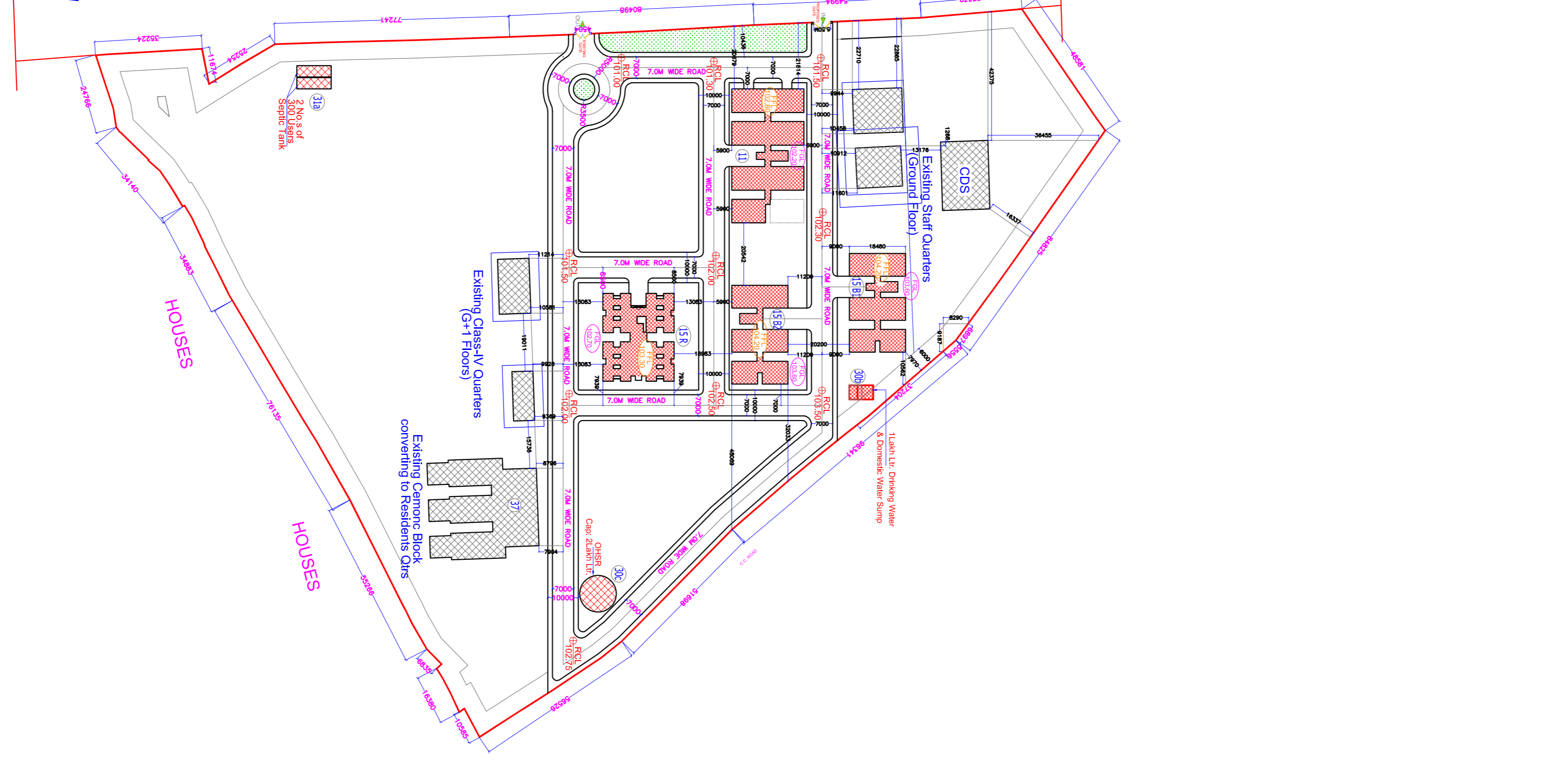

**PART-A**  
AREA : 36.07 ACRES

**PART-B**  
AREA : 10.99 ACRES

**S.S. CONSULTANTS**

PROJECT CONSULTANTS  
#17&9, JAGBAR BUILDINGS,  
BECOMPET, HYDERABAD-16  
PH: 65310240, 65310954,  
FAX NO: 040-65312949,  
email: ssecos@rediffmail.com

DATE: 26-07-2014  
SCALE: N.T.S  
DEALT BY: MOHN  
ARCHITECT: N.V.SRINIVASA RAO  
CHECKED BY: S.S.RAO

**01**

DRG.NO.-SST/MS/DC/IRMS/ADILABAD/PROP-SITE PLAN/01

**TITLE :**  
SITE PLAN SHOWING EXISTING BUILDINGS AND UNDER CONSTRUCTION BUILDING

**CLIENT :**  
TELANGANA MEDICAL SERVICES  
INFRASTRUCTURE DEVELOPMENT CORPORATION  
(An Enterprise of Government of Telangana)  
D.M. & H8 CAMPUS  
SULTAN BAZAR, KOTI, HYDERABAD.

**NOTES :**  
ALL DIMENSIONS ARE IN METERS  
GRID INTERVAL, 30 Mtrs x 30 Mtrs  
CONTOUR INTERVAL, 0.5 Mtrs  
SCALE TO BE FOLLOWED

**PROJECT :**  
RAJIV GANDHI INSTITUTE OF MEDICAL SCIENCES (RIMS) AT ADILABAD, A.P.

**AREA :**  
47.06 Acres  
(or) 2,27,770.37 Sq.Yds  
(or) 1,90,445.04 Sq.Mts.

**REV**

REV	DATE	DESCRIPTION	CHNGD REFERENCE
1	28-12-2007	SUBMITTAL - WEST CORNER BOUNDARY	
2	24-06-2008	BUILDINGS 2,3 & 4 RELOCATED FROM SOUTH SIDE TO NORTH SIDE AS PER REVISED SOUTH-WEST CORNER BOUNDARY	
3	14-07-2008	01,2,5 RELOCATED AS PER USER REQUIREMENT FROM SOUTH SIDE TO NORTH SIDE AS PER USER REQUIREMENT	
4	22-11-2012	NEW BUILDINGS AND EXTENSION OF EXISTING STRUCTURES ARE PROPOSED AS PER THE USER REQUIREMENT	
5	21-02-2013	NEW BUILDINGS AND EXTENSION OF EXISTING STRUCTURES ARE PROPOSED AS PER THE USER REQUIREMENT	